



Remote access to your Crankk gateway with Tailscale

1. Go to <https://login.tailscale.com/admin/settings/keys> or visit your local dashboard and click on the **Tailscale tab**, then press on **Authorization Keys**.
2. Register a new account.
3. Go to Settings > Keys:
-Generate an authentication key.

The screenshot shows the Tailscale admin dashboard. At the top, there is a navigation bar with the following items: Machines, Services, Users, Access controls, Logs, DNS, and Settings (which is highlighted). On the left side, there is a sidebar menu with the following items: Tailnet Settings (General, User management, Device management, OAuth clients, Webhooks, Contact preferences, Billing) and Personal Settings (Keys). The main content area is titled 'Keys' and contains the following text: 'View and manage your Auth keys and API access tokens. Your private device keys are not included here: they are always private, stay on your device, and are never shared with Tailscale. [Learn more](#) →'. Below this text, there are two sections: 'Auth keys' and 'API access tokens'. The 'Auth keys' section has a 'Generate auth key...' button and a message: 'You don't have any auth keys yet'. The 'API access tokens' section has a 'Generate access token...' button and a message: 'You don't have any access tokens yet'.

- Check both **Reusable** and **Ephemeral**.

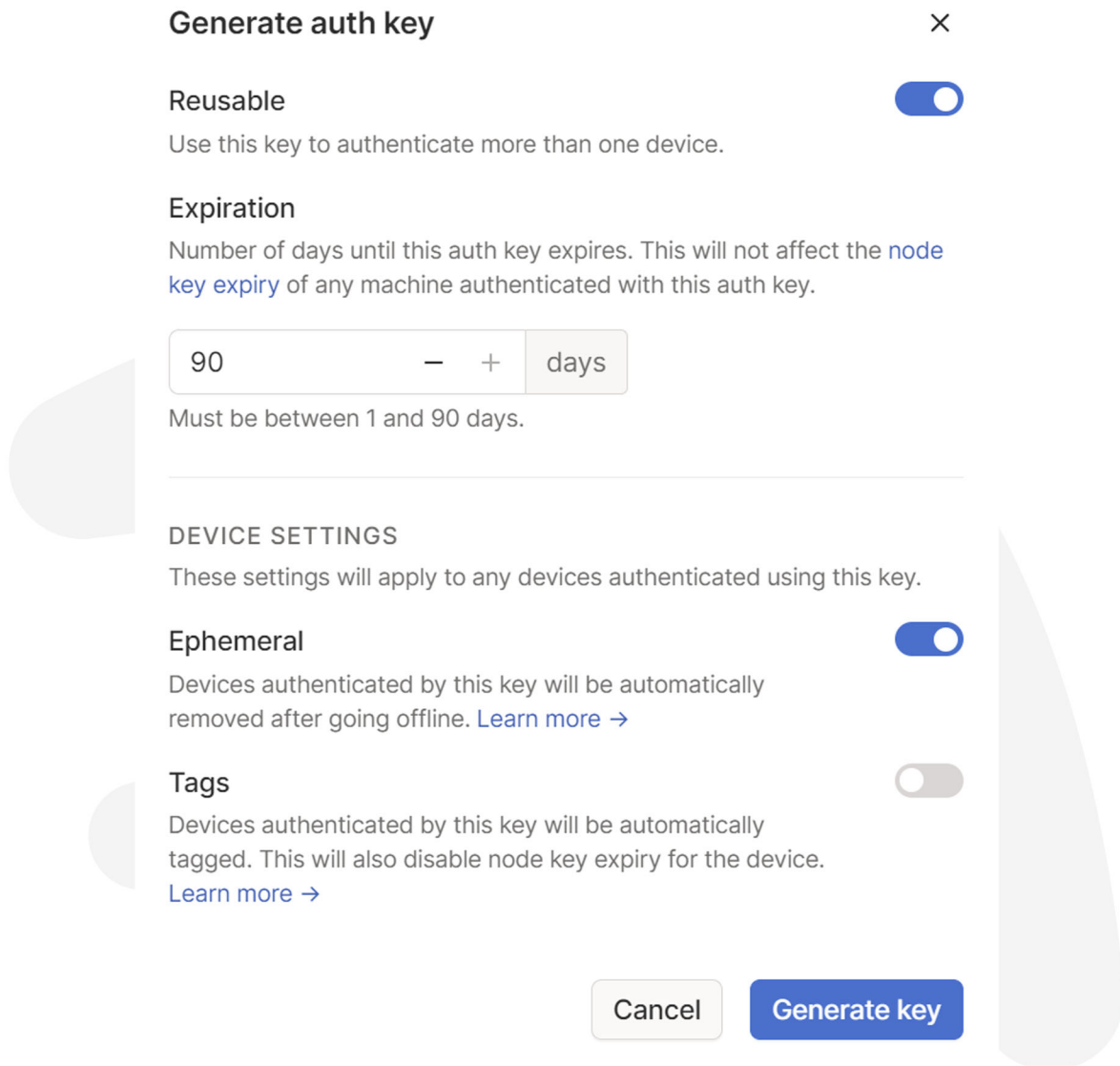

- Write down this key and keep it safe.

4. Install **Tailscale** on your gateway

- Go to your gateway local dashboard on the **Tailscale** tab

< Crankk - Local Dashboard ☀

Tailscale VPN

 Tailscale VPN provides a secure and private connection to your gateways. To use the service you need to register and create an [authorization key](#). You can use the same key with all your gateways.

Authentication Key

Gateway Alias

Subnet routers

- Paste the key you just generated, set up a nickname for your device (if desired), and press **Install**. This will install everything necessary to connect remotely to your device.

5. Install Tailscale to the device you will be login to your gateways - <https://tailscale.com/download>

- After the installation is complete, a pop-up window will appear, and you will be redirected to the Tailscale website to connect your device.



Connect device

Do you want to connect the device PChome to the testemail@gmail.com tailnet? This may give the device access to other resources in your tailnet, based on ACLs.

▶ Device details

Connect

6. How to connect to a gateway remotely

When you go to Machines tab in your account, you can see all the registered devices and their IPs.

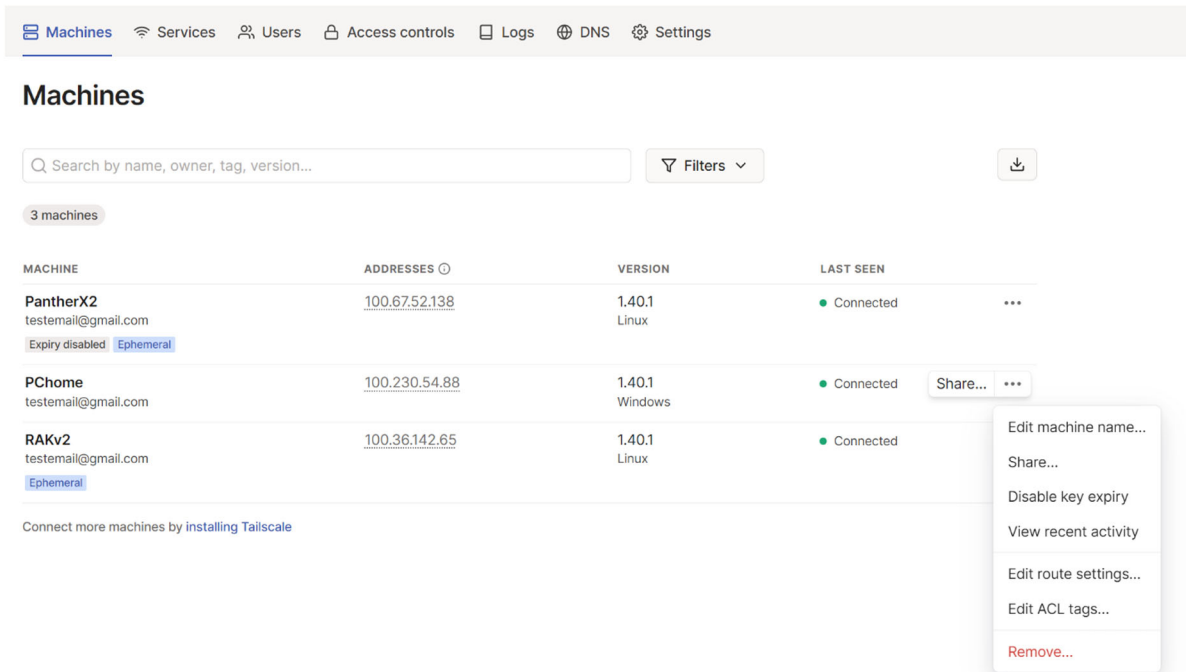

The screenshot shows the 'Machines' tab in a web interface. At the top, there are navigation links: Machines, Services, Users, Access controls, Logs, DNS, and Settings. Below the navigation is a search bar with the placeholder text 'Search by name, owner, tag, version...' and a 'Filters' dropdown. A '3 machines' indicator is shown. The main content is a table with columns: MACHINE, ADDRESSES, VERSION, and LAST SEEN. Three machines are listed: PantherX2 (Linux, IP 100.67.52.138), PChome (Windows, IP 100.230.54.88), and RAKv2 (Linux, IP 100.36.142.65). A context menu is open over the RAKv2 machine, showing options: Edit machine name..., Share..., Disable key expiry, View recent activity, Edit route settings..., Edit ACL tags..., and Remove... (in red). Below the table, there is a note: 'Connect more machines by installing Tailscale'.

MACHINE	ADDRESSES	VERSION	LAST SEEN
PantherX2 testemail@gmail.com Expiry disabled Ephemeral	100.67.52.138	1.40.1 Linux	Connected
PChome testemail@gmail.com	100.230.54.88	1.40.1 Windows	Connected
RAKv2 testemail@gmail.com Ephemeral	100.36.142.65	1.40.1 Linux	Connected

Disable key expiry if you don't want to change the key every 90 days.

You can use separate key for every gateway or use one key to rule them all!

7. Connect to the local dashboard

You can also connect remotely to your device local dashboard, here is how to do it.

From PC or mobile phone (with installed Tailscale) open a new browser tab and type in your gateway IP (as seen in your Tailscale account) followed by :17080 to access the local dashboard.

Here is an example connection to the local dashboard of the **RAKv2 gateway** above:

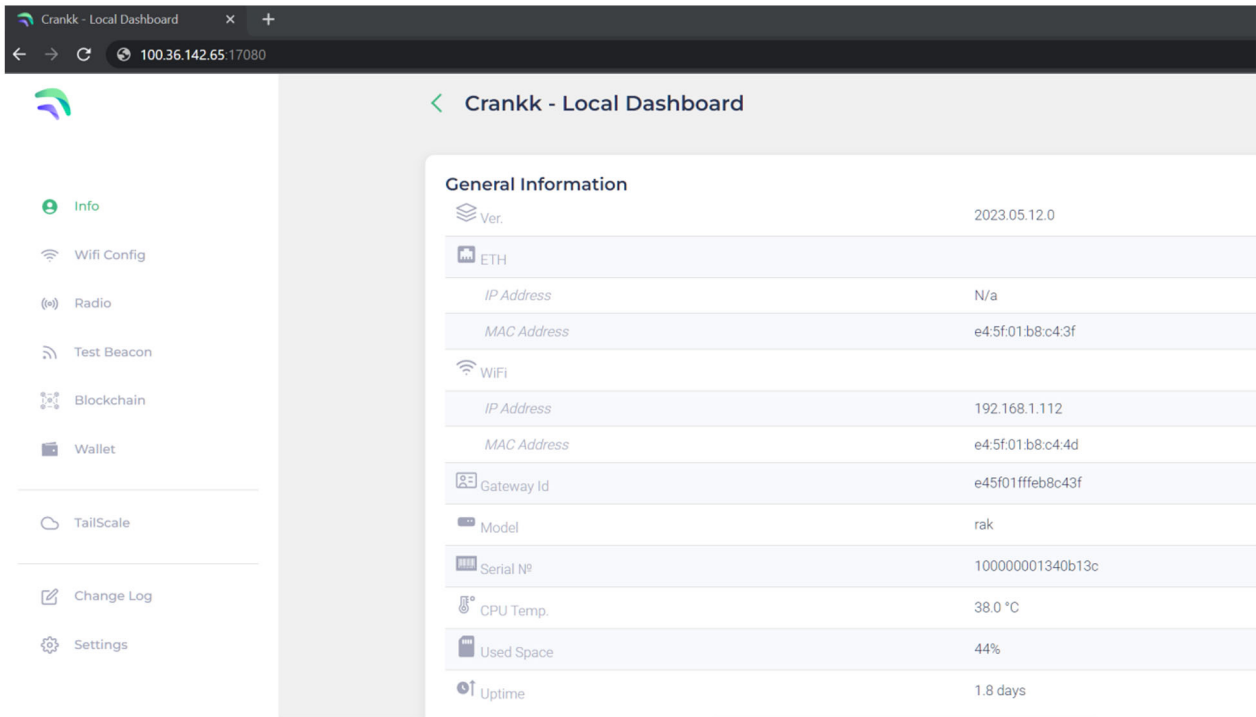

You can use the IPs to log in to your gateways via PuTTY (crankk@IP) or provide them to the Crankk technical support team if requested in the Discord ticket.